

## INSTALLATION GUIDE: STAINLESS APPLIANCE OVERLAY PANEL

Overlay panels are designed to cover the appliance(s), providing a more uniform appearance. Because every appliance is different, the Overlay panels may mount higher or lower on the appliance door to stay aligned with the adjacent cabinet doors. The Overlay panels are manufactured without mounting holes and will need to be drilled on-site.

1. Install all the outdoor kitchen cabinets and appliances. Ensure the entire project is level, square, and plumb.
2. Install the supplied double sided tape on either the Overlay panel or the appliance door.

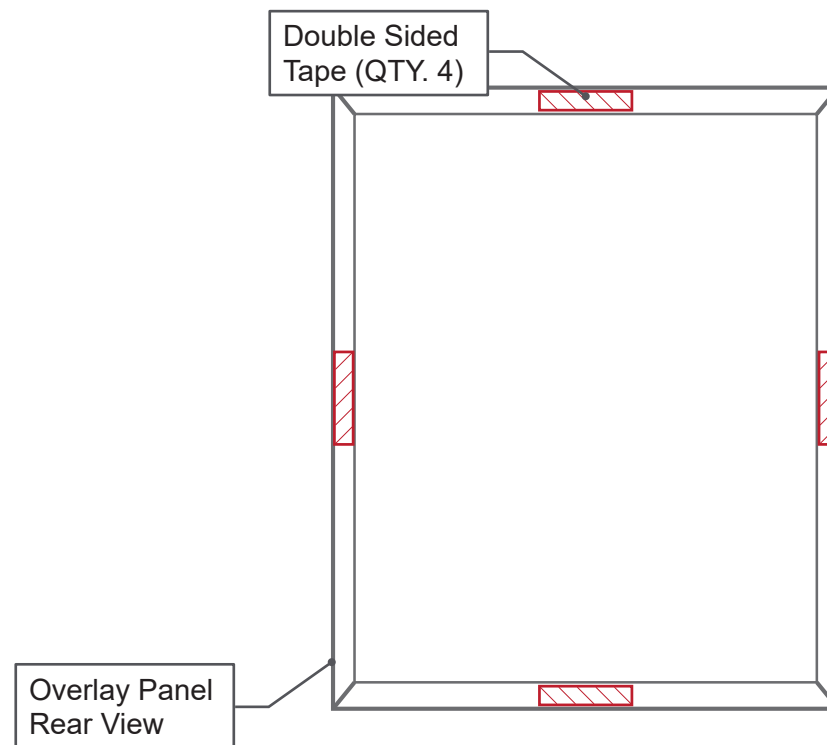

## INSTALLATION GUIDE: STAINLESS APPLIANCE OVERLAY PANEL

3. Mount the Overlay panel to the appliance door, aligning the panel vertically and horizontally with the adjacent cabinet doors.

4. Remove the refrigerator door, keeping the Overlay panel in place.

5. Screw on the Overlay panels through the appliance door using the supplied "#8 x 1.125" hardware and per the appliance manufacturer's instructions (Note: 1/8" bit is recommended). Use the QR codes below to find your manufacturer.

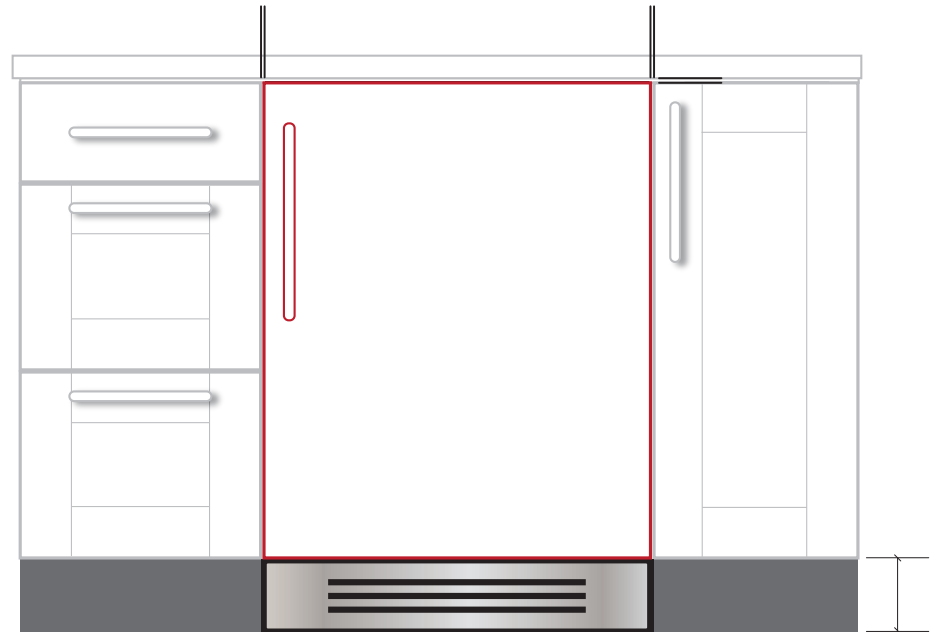

Hoshizaki



Scotsman



Perlick



True



Sub-Zero



Summit Door Panel



Summit Drawer Panel

